

	Runoff Coefficients	Catchment A		Catchment B		Catchment C		Total (m2)	
		Gross Areas (m2)	Factored Areas (m2)	Gross Areas (m2)	Factored Areas (m2)	Gross Areas (m2)	Factored Areas (m2)	Gross Area (m2)	Factored Areas (m2)
Duplex Roof - Draining to SUDs	0.50	5,100	2,550	-	-	819	410	5,919	2,960
Apartment - Green Roof	0.75	5,013	3,759	1,380	1,035	2,209	1,657	8,602	6,451
Paved Areas - Draining to Gullies	0.80	6,231	4,985	924	739	2,147	1,718	9,303	7,442
Paved Areas - Draining to SUDs (Permeable Driveways)	0.50	3,135	1,568	224	112	966	483	4,326	2,163
Green Podium (Over Drainage Board)	0.75	2,912	2,184	-	-	-	-	2,912	2,184
Soft Landscaping	0.15	13,964	2,095	3,470	521	5,071	761	22,505	3,376
		36,355	17,141	5,999	2,407	11,213	5,028	53,566	24,575

PROPOSED RUNOFF COEFFICIENTS AND FACTORED IMPERMEABLE AREAS

- LIST OF IRISH WATER WASTEWATER STANDARD DETAILS BROUGHT INTO THE CONTRACT**
- STD-WW-01 TYPICAL LAYOUT FOR SEWER WITHIN NEW DEVELOPMENT
  - STD-WW-02 DRAIN AND SERVICE CONNECTION PIPEWORK
  - STD-WW-03 TYPICAL SERVICE LAYOUT INDICATING SEPARATION DISTANCES
  - STD-WW-04 TYPICAL SERVICE LAYOUT INDICATING SEPARATION DISTANCES
  - STD-WW-05 TYPICAL SERVICE LAYOUT INDICATING SEPARATION DISTANCES
  - STD-WW-06 RESTRICTIONS ON TREES/SHRUBS PLANTING ADJACENT TO SEWERS
  - STD-WW-07 TRENCH BACKFILL & BEDDING
  - STD-WW-08 CONCRETE BED, HAUNCH & SURROUND TO WASTEWATER PIPES
  - STD-WW-09 BLOCKWORK MANHOLE (<450mm)
  - STD-WW-10 PRE-CAST CONCRETE MANHOLE
  - STD-WW-11 IN-SITU CONCRETE MANHOLE
  - STD-WW-12 BACKDROP MANHOLES
  - STD-WW-13 PRIVATE SIDE INSPECTION CHAMBER
  - STD-WW-14 THURST BLOCKS FOR RISING MAINS
  - STD-WW-15 SCOUR VALVE CHAMBER (FOUL RISING MAIN <200mm)
  - STD-WW-16 SLUICE VALVE DETAILS FOR RISING MAINS DUCTILE IRON (DI) PIPE (<200mm)(SHEET 1 OF 2)
  - STD-WW-17 SLUICE VALVE DETAILS FOR RISING MAINS POLYETHYLENE (PE) PIPE (<200mm)(SHEET 2 OF 2)
  - STD-WW-18 AIR VALVE CHAMBER (FOUL RISING MAIN <200mm)
  - STD-WW-19 DUCT CHAMBER
  - STD-WW-20 EMERGENCY OVERFLOW STRUCTURE
  - STD-WW-21 TYPICAL DITCH/STREAM CROSSING FOR GRAVITY MAIN (SHEET 1 OF 2)
  - STD-WW-22 TYPICAL DITCH/STREAM CROSSING FOR RISING MAIN (SHEET 2 OF 2)
  - STD-WW-23 TYPICAL BRIDGE CROSSING FOR RISING MAIN (SHEET 1 OF 2)
  - STD-WW-24 TYPICAL BRIDGE CROSSING FOR RISING MAIN (SHEET 2 OF 2)
  - STD-WW-25 SECURITY GATE & FENCING
  - STD-WW-26 INDICATIVE PUMPING STATION LAYOUT
  - STD-WW-27 FLOW METER CHAMBER (FOUL RISING MAIN <200mm)
  - STD-WW-28 INDICATIVE SUBMERGIBLE PUMPING STATION
  - STD-WW-29 INDICATIVE PRE-CAST CONCRETE SUBMERGIBLE PUMPING STATION
  - STD-WW-29 RISING MAIN DISCHARGE MANHOLE
  - STD-WW-30 KOSK TYPE 1 PUMPING STATION & WET KOSK (SHEET 1 OF 2)
  - STD-WW-31 KOSK TYPE 2 + 3 PUMPING STATION & WET KOSK (SHEET 2 OF 2)
  - STD-WW-32 HARVESTING AREA PUMPING STATION (PERMEABLE & IMPERMEABLE)
  - STD-WW-33 LAMP BOLLARD & LAMP STANDARD
  - STD-WW-34 VENT STACK
- GENERAL NOTES:**
1. ALL WORKS SHALL BE CONSTRUCTED IN ACCORDANCE WITH THE WORKS REQUIREMENTS.
  2. ALL DIMENSIONS IN METRES UNLESS SPECIFIED OTHERWISE.
  3. ALL CO-ORDINATES ARE TO HIGH TRANSDUCED MEASUREMENT.
  4. ALL LEVELS ARE TO CROWN DATUM (M.A.S. HEAD).
  5. ALL TEMPORARY DIGITS & OPERATIONS MANAGEMENT SHALL COMPLY FULLY WITH THE WORKS REQUIREMENTS.
  6. THE CONTRACTOR MUST ALWAYS CONSULT WITH LOCAL AUTHORITY DEPARTMENT AS DIRECTED IN THE WORKS REQUIREMENTS.
  7. ALL VEHICULAR & PEDESTRIAN CYCLE & PRIVATE ACCESS ISSUES WITHIN AND SURROUNDING THE WORKS EXTENTS MUST BE MANAGED THROUGHOUT THE WORKS IN ACCORDANCE WITH THE CONTRACTOR APPROVED TEMPORARY DIGITS & OPERATIONS MANAGEMENT PLAN.
- DRAINING SPECIFIC NOTES:**
1. ALL DRAWINGS TO BE CHECKED BY CONTRACTOR ON SITE AND EXISTING WORKS TO BE IDENTIFIED BEFORE WORK COMMENCES.
  2. CONTRACTOR SHALL VERIFY WORKS AS TO THE ACCURACY OF EXISTING ELEVATIONS & THE LOCATION OF EXISTING SERVICES ON SITE PRIOR TO COMMENCEMENT OF WORKS ON SITE.
  3. ALL WORKS TO BE CONSTRUCTED IN ACCORDANCE WITH THE IWA SPECIFICATION FOR ROAD WORKS UNLESS NOTED OTHERWISE.
  4. MANHOLE COVER LEVELS ARE TO CONFORM WITH FINISHED ROAD AND FINISH LEVELS.
  5. ALL SURFACE WATER DRAINAGE WORKS TO BE IN ACCORDANCE WITH THE REQUIREMENTS OF THE LOCAL AUTHORITY'S CODE OF PRACTICE FOR DRAINAGE AND THE SUDS.
  6. ALL FILL DRAINAGE WORKS TO BE IN ACCORDANCE WITH IWA WATER CODE OF PRACTICE FOR INSTALLED SUPPLY AND WASTEWATER INFRASTRUCTURE STANDARDS DETAIL.
  7. FLOOR SEWERS TO BE CONCRETE PIPES (SPICAT AND SOCKET JOINTS AND RUBBER RING FITTINGS COMPLYING WITH BS EN 1916) OR THERMOPLASTIC STRUCTURED WALL PIPES (COMPLYING WITH THE PROVISION OF BS EN 12458 AND BS 4-35-01 2000) AND COMPLY WITH THE REQUIREMENTS OF THE IWA WATER CODE OF PRACTICE.
  8. ALL SURFACE WATER SEWERS TO BE CLASS H CONCRETE TO BS EN 12458 & BS 4-35-01.
  9. SURFACE WATER COLLECTOR DRAINS 100mm DIA. DIA. RIGID CONNECTIONS TO BE 100mm DIA.
  10. THIS DRAWING IS BASED ON TOPO SURVEY BY JAL SURVEY LIMITED DATE 05/05/2023.
  11. CONTRACTOR SHALL INSPECT THE ROUTE & CONFIRM LOCATIONS OF ALL EXISTING UTILITIES, SERVICES & ASPECTS IMPACTING CONSTRUCTION OF THE WORKS.
  12. CONTRACTOR SHALL VERIFY THE ROUTE & CONFIRM LOCATIONS OF ALL EXISTING UTILITIES, SERVICES & ASPECTS IMPACTING CONSTRUCTION OF THE WORKS.
  13. THE CONTRACTOR AND/OR ARCHITECT ARE RESPONSIBLE FOR CONNECTIONS INTO THE BUILDING.
  14. CONTRACTOR SHALL INSPECT THE ROUTE & CONFIRM LOCATIONS OF ALL EXISTING UTILITIES, SERVICES & ASPECTS IMPACTING CONSTRUCTION OF THE WORKS.
  15. NOTE THAT THE CONTRACTOR AND/OR ARCHITECT ARE RESPONSIBLE FOR CONNECTIONS INTO THE BUILDING.

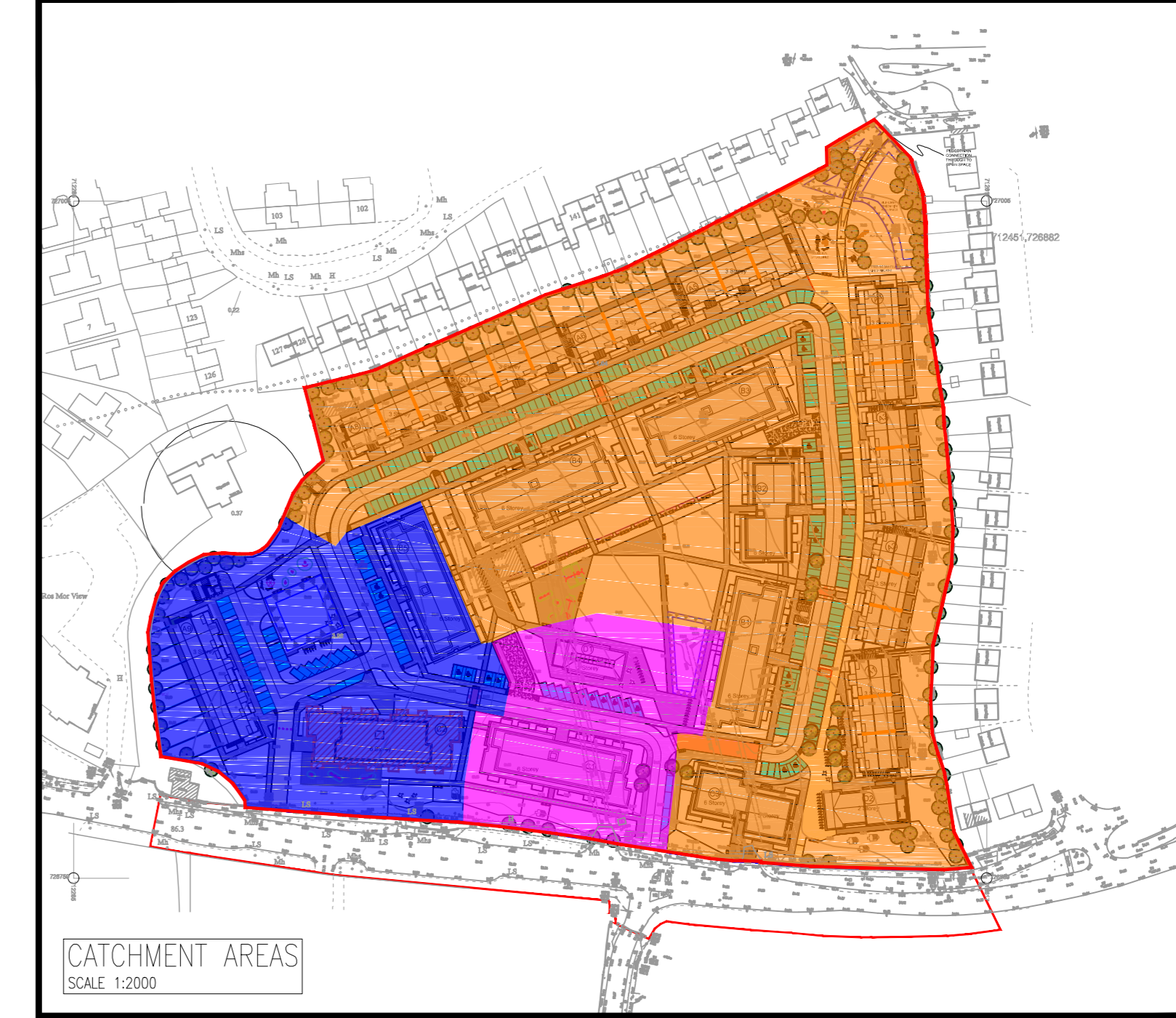
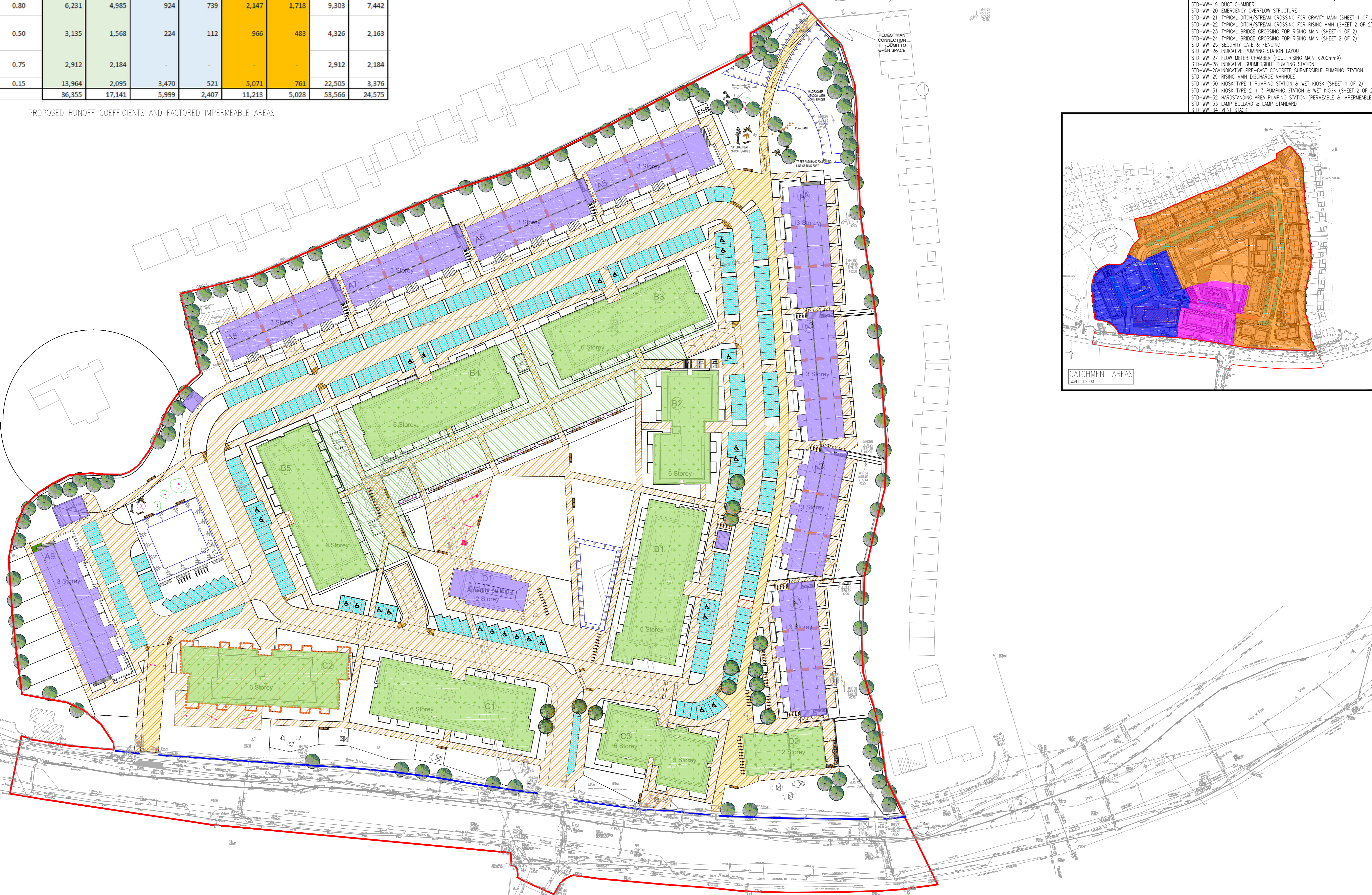

- LEGEND:**
- SITE A BOUNDARY
  - GREEN ROOF (SUDS BLANKET OR SIMILAR APPROVED)
  - ROOF AREA DRAINING TO SUDS
  - CATCHMENT AREA A
  - CATCHMENT AREA B
  - CATCHMENT AREA C
  - GREEN PODIUM
  - PAVED AREAS DRAINING TO TRENCHES OR GULLIES
  - PAVED AREAS DRAINING TO SUDS

PFI 06/11/23 ISSUED FOR PLANNING  
 Job No. 2304  
 Date 06/11/23  
 Author J.B.  
 Checked J.B.  
 Approved J.B.  
 Issue Purpose PLANNING

**DBFL Consulting Engineers**  
 Civil Structural & Transportation Engineering  
 www.dbfl.ie  
 100, The Quay, Dublin 1, Ireland  
 Phone: +353 1 400 4000  
 Fax: +353 1 206 500

project ref: **RESIDENTIAL DEVELOPMENT SCHOLARSTOWN**  
 drawing title: **SURFACE WATER CATCHMENT AREAS LAYOUT**  
 architect: **JOHN FLEMING ARCHITECTS**

ORDNANCE SURVEY IRELAND LICENCE No. EN 0017919  
 © ORDNANCE SURVEY IRELAND GOVERNMENT OF IRELAND  
 drawing no: **SCH-DBF-ZZ-XX-DR-C-3104** P01